

# MFN

## CADDY MACROFIX NON-INSULATED M8/M10

Part Number	Article Number	Pipe Range	Rod Size	Wrench size for M8/M10 Nut	Wrench size for M6 screw	Tightening torque for M6 screw	RAL Product Load Rating *
MFN019EG	586101	15– 19 mm, 10 DN	M8/M10	13mm	10mm	2 Nm	1,000 N
MFN023EG	586102	19 - 23 mm, 15 DN					
MFN029EG	586103	23 – 29 mm, 20 DN					
MFN035EG	586104	29 - 35 mm, 25 DN					
MFN041EG	586105	35 – 41 mm					
MFN048EG	586106	41 – 48 mm, 32 DN					
MFN054EG	586107	48 – 54 mm, 40 DN					1,500 N
MFN062EG	586108	54 - 62 mm, 50 DN					
MFN072EG	586109	62 – 72 mm					
MFN083EG	586110	73 - 83 mm, 65 DN					
MFN093EG	586111	83 - 93mm, 80 DN					
MFN103EG	586112	93 - 103mm, 90 DN					2,000 N
MFN113EG	586113	103 – 113mm					
MFN123EG	586114	113 - 123mm, 100 DN					
MFN133EG	586115	123 - 133mm					
MFN143EG	586116	133 - 143mm, 125 DN					2,500 N
							3,000 N

\* RAL Product Load Rating per RAL-GZ 655.

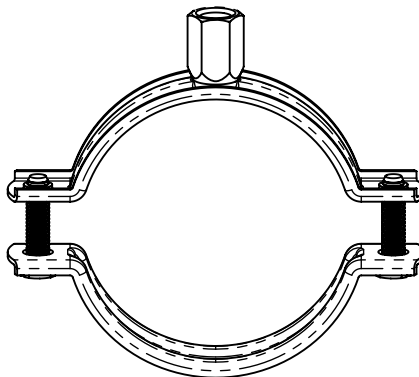

#### WARNING:

- Pentair products shall be installed and used only as indicated in Pentair product instruction sheets and training materials. Instruction sheets are available at [www.erico.pentair.com](http://www.erico.pentair.com) and from your Pentair customer service representative.
- PENTAIR products must never be used for a purpose other than the purpose for which they were designed or in a manner that exceeds specified load ratings.
- All instructions must be **completely** followed to ensure proper and safe installation and performance.
- Improper installation, misuse, misapplication or other failure to completely follow Pentair's instructions and warnings may cause product malfunction, property damage, serious bodily injury and/or death, and void your warranty.
- Products that are manufactured using spring steel components shall be used only in a non-corrosive indoor environment.
- All pipe supports, hangers, intermediate components and structural attachments must **ONLY** be used as described herein and are **NEVER** to be used for any other purpose.

NOTE: All load ratings are for static conditions and do not account for dynamic loading such as wind, water or seismic loads, unless otherwise noted.

The customer is responsible for:

- Conformance to all governing codes.
- The integrity of structures to which the products are attached, including their capability of safely accepting the loads imposed, as evaluated by a qualified engineer.
- Using appropriate industry standard hardware as noted above.

#### SAFETY INSTRUCTIONS:

All governing codes and regulations and those required by the job site must be observed.  
Always use appropriate safety equipment such as eye protection, hard hat, and gloves as appropriate to the application.



Pentair, CADDY, ERICO CADWELD, ERICO CRITEC, ERICO, ERIFLEX, and LENTON are owned by Pentair or its global affiliates. All other trademarks are the property of their respective owners. Pentair reserves the right to change specifications without prior notice.

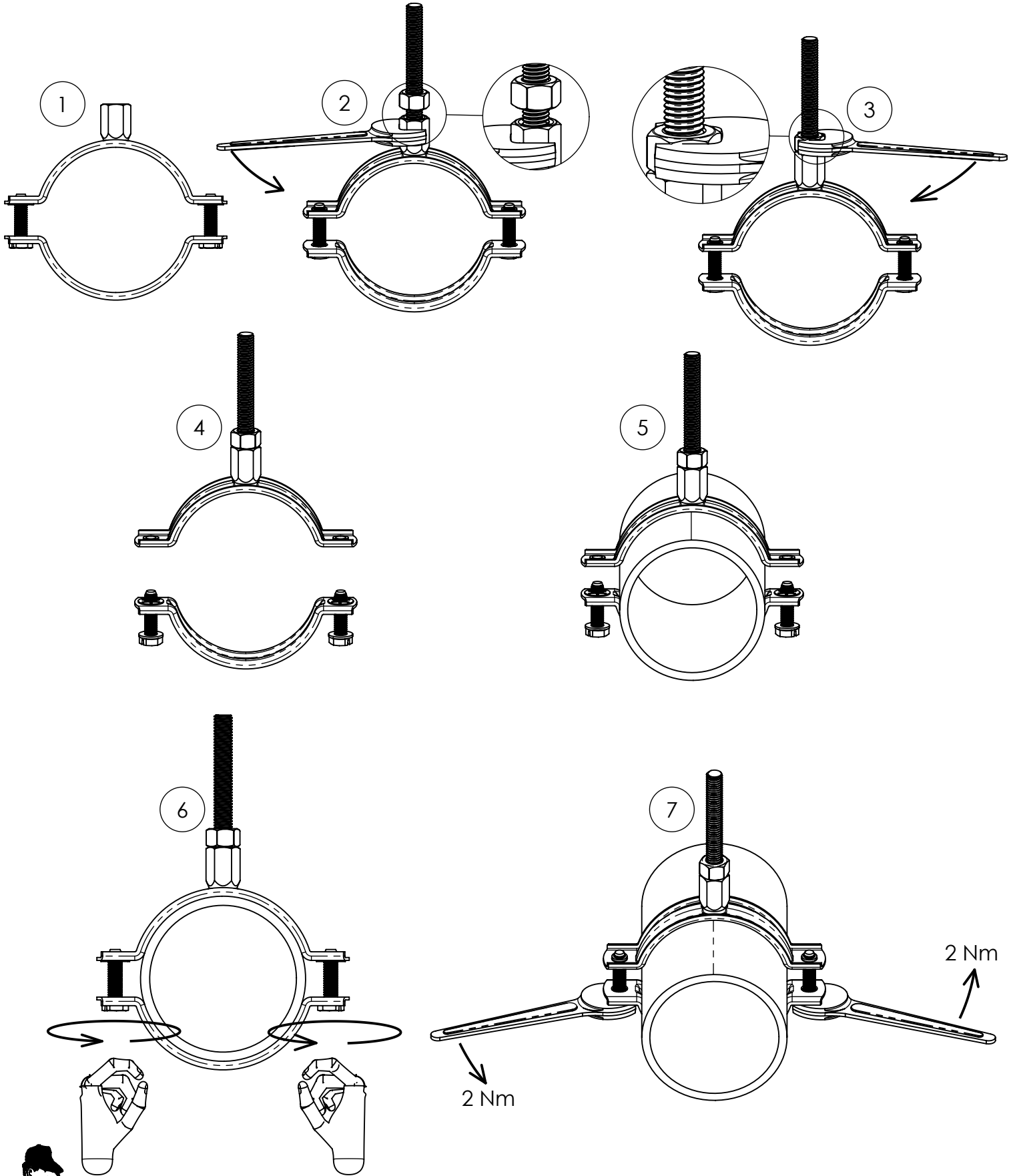

Pentair, CADDY, ERICO CADWELD, ERICO CRITEC, ERICO, ERIFLEX, and LENTON are owned by Pentair or its global affiliates. All other trademarks are the property of their respective owners. Pentair reserves the right to change specifications without prior notice.