

## DESCRIZIONE GENERALE STEELPRES

STEELPRES GENERAL DESCRIPTION • STEELPRES ALLGEMEINE BESCHREIBUNG  
STEELPRES DESCRIPTION GÉNÉRALE • DESCRIPCIÓN GENERAL STEELPRES

Tubo Steelpres in verghe da 6 m. Tutte le dimensioni in mm.

Steelpres pipes in 6m length. All dimensions in mm.

Steelpres Leitungsröhre, in 6 m Stangen. Alle Abmessungen in mm.

Tubes Steelpres en longueurs 6 m. Tous les dimensions en mm.

Tubo Steelpres en fardos de 6 metros. Todas las dimensiones se indican en mm.

Raccordi a pressare Steelpres con O-ring di sicurezza (15÷54 mm) in EPDM nero.

Steelpres press fittings with black EPDM safety sealing ring (15÷54 mm).

















Steelpres Pressfittinge mit schwarzem EPDM Sicherheitsdichtring (15÷54 mm).

Raccords a sertir Steelpres avec joint de sureté EPDM noir (15÷54 mm).

Accesorio a prensar Steelpres con junta torica de seguridad en EPDM negra (15÷54 mm)

## CERTIFICAZIONI

CERTIFICATION • ZERTIFIZIERUNG  
CERTIFICATION • CERTIFICACIÓN

		SYSTÈMES DE CANALISATIONS DE DISTRIBUTION D'EAU - SYSTÈME STEELPRES	79 - 1975	Ø 15 – 108 mm
		Tube fittings - Steelpres	P-14797	Ø 15 – 108 mm
		STEELPRES PRESSFITTINGSYSTEM	POCCIT. Д E01.H37816	Ø 15 – 108 mm
		HORGANYZOTT ACÉL CSÖVEK ÉS PRÉSIDOMOK STEELPRES PVC BEVONATOS HORGANYZOTT ACÉL CSÖVEK	A-2156/2012	Ø 15 – 108 mm
		LACZNIKI ZAPRASOWYWANE ZE STALI SYSTEMU INOXPRES I STEELPRES DO LACZENIA RUR ZE STALI	AT-15-7863/2008	Ø 15 – 108 mm
		DAU 11/073 STEELPRES	DAU 11 - 073	Ø 15 – 108 mm
		SYSTEM OF STEEL PIPES AND STEEL COMPRESSION FITTINGS STEELPRES	B-30-00055-11 Rev.1	Ø 15 – 108 mm
		SYSTÉM OCEĽOVÝCH RÚR A OCEĽOVÝCH LISOVACÍCH TVAROVIEK STEELPRES	0026/104/2011	Ø 15 – 108 mm



**316/005**

≤54 B 40 41

≥76 B 40 42

**Zincato esternamente**  
 Outside galvanized  
 Außen verzinkt  
 Galvanisés extérieur  
 Galvanizado exterior

**Mat. Nr.: 1.0215 (E 220 CR2S4)**

CODICE CODE	Dimensioni Dimensions mm x mm	Ø int mm	L m	 kg/m	Volume Volume l/m	Confezione min. Minimum package m	Fascio Bundle m
316012005	12 x 1,2	9,6	6	0,320	0,072	150	1014
316015005	15 x 1,2	12,6	6	0,408	0,125	120	1014
316018005	18 x 1,2	15,6	6	0,497	0,191	90	1014
316022005	22 x 1,5	19	6	0,824	0,284	60	762
316028005	28 x 1,5	25	6	1,052	0,491	60	546
316035005	35 x 1,5	32	6	1,320	0,804	30	546
316042005	42 x 1,5	39	6	1,620	1,194	30	366
316054005	54 x 1,5	51	6	2,089	2,042	30	366
316076005	76,1 x 2,0	72,1	6	3,652	4,080	on request	114
316088005	88,9 x 2,0	84,9	6	4,290	5,660	on request	114
316108005	108 x 2,0	104	6	5,230	8,490	on request	114

**Raccomandato per impianti di riscaldamento**  
**Recommended for heating installation**  
**Empfeht fuer Heizunagsanlagen**  
**Recommandé pour installations de chauffage**  
**Recomendado para instalaciones de calefacción**

**316/003**
**≤54 B 40 44**
**≥76 B 40 45**
**Zincato esternamente con rivestimento in PP**

Outside galvanized with PP-coating

Außen verzinkt mit PP-Ummantelung

Galvanisés extérieur avec revêtement PP

Galvanizado exterior recocido

**Mat. Nr.: 1.0215 (E 220 CR2S4) + PP**

CODICE CODE	Dimensioni Dimensions mm x mm	Ø int mm	L m		Volume Volume l/m	Confezione min. Minimum package m	Fascio Bundle m
316012003	12 x 1,2	9,6	6	0,320	0,072	150	1014
316015003	15 x 1,2	12,6	6	0,408	0,125	120	1014
316018003	18 x 1,2	15,6	6	0,497	0,191	90	1014
316022003	22 x 1,5	19	6	0,824	0,284	60	762
316028003	28 x 1,5	25	6	1,052	0,491	60	546
316035003	35 x 1,5	32	6	1,32	0,804	30	546
316042003	42 x 1,5	39	6	1,62	1,194	30	366
316054003	54 x 1,5	51	6	2,098	2,042	30	366
316076003	76,1 x 2,0	72,1	6	3,652	4,080	12	114
316088003	88,9 x 2,0	84,9	6	4,290	5,660	12	114
316108003	108 x 2,0	104	6	5,230	8,490	6	114

Spessore polipropilene: 1 mm

Polypropylene thickness: 1 mm

Dicken polypropylen: 1 mm

Polypropylène d'épaisseur: 1 mm

Polipropileno de espesor: 1 mm

**Raccomandato per impianti di raffrescamento**
**Recommended for cooling installation**
**Empfehlert fuer Kuehlungsanlagen**
**Recommandé pour installations de refroidissement**
**Recomendado para instalaciones de refrigeracion**



**316/002**

≤54 B 40 43

≥76 B 40 46

**Zincato internamente ed esternamente**

Inside and outside galvanized  
Innen und außen verzinkt  
Galvanisés intérieur et extérieur  
Galvanizado interior y exterior

**Mat. Nr.: 1.0031 (E 190 CR2S4)**

CODICE CODE	Dimensioni Dimensions mm x mm	Ø int mm	L m	 kg/m	Volume Volume l/m	Confezione min. Minimum package m	Fascio Bundle m
316022002	22 x 1,5	19	6	0,824	0,284	60	60
316028002	28 x 1,5	25	6	1,052	0,491	60	60
316035002	35 x 1,5	32	6	1,320	0,804	30	30
316042002	42 x 1,5	39	6	1,620	1,194	30	30
316054002	54 x 1,5	51	6	2,098	2,042	30	30
316076000	76,1 x 2,0	72,1	6	3,652	4,080	12	12
316088000	88,9 x 2,0	84,9	6	4,290	5,660	12	12
316108000	108 x 2,0	104	6	5,230	8,490	6	6

**Solo per impianti sprinkler ad umido.**

**Only for wet sprinkler systems.**

**Nur für Sprinkler Nassleitungen.**

**Seulement pour système anti-incendie sprinkler humide.**

**Sólo para instalaciones Sprinkler en humedo.**

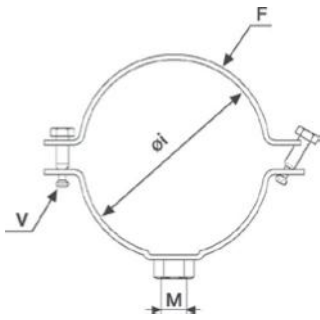

### 351

#### Collare per tubo Steelpres

Clamp for Steelpres pipe

Rohrschellen für Steelpres Rohr

Collier pour tube Steelpres

Abrazadera para tubo Steelpres

Materiale: St. W 24

Nota: Dado saldato con puntatura elettrica. Sgancio brevettato.

CODICE CODE	Øi mm	F lg x sp mm	V mm	M	g	Box	Rolls
351150001*	15	20 x 2,5	M 6 x 20	M 8	60	25*	2800
351308000	18	20 x 2,5	M 6 x 20	M 8	63	50*	5600
351102000	22	20 x 2,5	M 6 x 20	M 8	65	50*	5600
351304000	28	20 x 2,5	M 6 x 25	M 8	69	50*	5600
351100000	32	20 x 2,5	M 6 x 25	M 8	78	50*	5600
351114000	42	20 x 2,5	M 6 x 25	M 8	89	25*	2800
351054000	54	20 x 2,5	M 6 x 25	M 8	100	25*	2800
351212000	76,1	30 x 2,5	M 6 x 25	M 10	187	10*	1920
351300000	88,9	30 x 2,5	M 6 x 25	M 10	215	10*	1120
351108000	108	30 x 2,5	M 6 x 25	M 10	232	10*	1120

(\*) Rivestimento in gomma - With rubber gasket - Mit Gummieinlage - Isophonique - Junta de goma

(\*\*) N°2 PEZZI PER CONFEZIONE - N°2 PIECES PER BAG

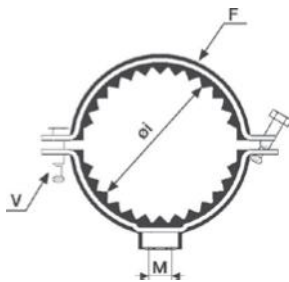

### 351/G

#### Collare gomma per tubo Steelpres

Clamp with rubber for Steelpres pipe

Rohrschelle mit Gummieinlage für Steelpres Rohr

Collier de fixation garniture isophonique pour tube Steelpres

Abrazadera isofónica para tubo Steelpres

Materiale: St. W 24

Gomma vulcanizzata: EPDM nera durezza 55 Shore (-20° C/+120° C)

Nota: Dado saldato con puntatura elettrica. Sgancio brevettato.

CODICE CODE	Øi mm	F lg x sp mm	V mm	M	g	Box	Rolls
351150001	15	20 x 2,5	M 6 x 20	M 8	60	25*	2800
351308001	18	20 x 2,5	M 6 x 20	M 8	69	25*	2800
351102001	22	20 x 2,5	M 6 x 20	M 8	79	25*	2800
351304001	28	20 x 2,5	M 6 x 25	M 8	88	25*	2800
351100001	35	20 x 2,5	M 6 x 25	M 8	105	25*	2800
351114001	42	20 x 2,5	M 6 x 25	M 8	109	25*	2800
35605400G*	54	20 x 2	M 6 x 20	M 8 - 10	108	25	3000
351212001	76,1	30 x 2,5	M 6 x 25	M 10	282	10*	720
351300001	88,9	30 x 2,5	M 6 x 25	M 10	342	5*	560
35610800G*	108	20 x 2	M 6 x 20	M 8 - 10	160	25	1300

(\*) \*Gomma staccabile - Detachable rubber - Abnehmbare Gummi - Caoutchouc amovible - Goma desmontable. Senza sgancio - Without hook - Ohne Abhang - Sans crochet - Sin el gancho.

(\*\*) N°2 PEZZI PER CONFEZIONE - N°2 PIECES PER BAG

Y 10 13

### 264

#### Barra filettata zincata

Galvanized threaded rod

Gewindestange verzink

Tige filetée galvanisée

Varilla roscada zincada

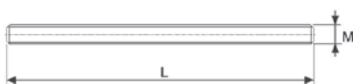

CODICE CODE	M	L mm	g	Box
264800001	M 8	1000	306	50
264100001	M 10	1000	480	25

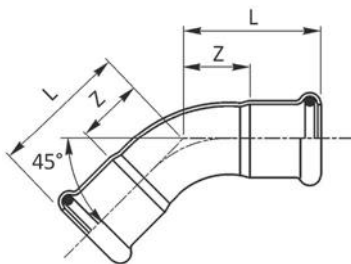

## 381/450

≤54 B 20 21

≥76 B 20 22

Curva 45° FF  
45° Elbow FF  
Bogen 45° II  
Coude FF 45°  
Curva 45° HH

Materiale: E 195 - 1.0034

O-ring: EPDM nero - black - Schwarz - noir - negro

CODICE CODE	De	L mm	Z mm			
381015450	15	27,5	7,5	37	20	400
381018450	18	29,5	9,5	45	20	300
381022450	22	32	11	59	20	200
381028450	28	37	14	87	10	200
381035450	35	43	17	124	10	60
381042450	42	51	21	175	4	40
381054450	54	62	30	282	2	20
381076450	76,1	131,5	76,5	910	2	2
381088450	88,9	144	84	1125	2	2
381108450	108	169	94	1620	2	2

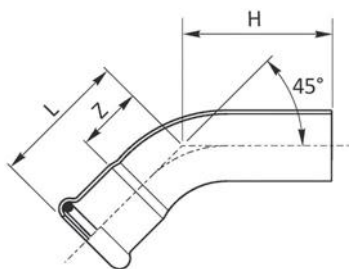

## 381/451

≤54 B 20 21

≥76 B 20 22

Curva 45° MF  
45° Elbow MF  
Bogen 45° IA  
Coude MF 45°  
Curva 45° HM

Materiale: E 195 - 1.0034

O-ring: EPDM nero - black - Schwarz - noir - negro

CODICE CODE	De	L mm	H mm	Z mm			
381015451	15	27,5	40	7,5	39	20	400
381018451	18	29,5	36	9,5	46	20	300
381022451	22	32	42	11	60	20	200
381028451	28	37	46	14	88	10	200
381035451	35	43	57	17	135	10	60
381042451	42	51	72	21	196	4	40
381054451	54	62	82	26	300	2	20
381076451	76,1	131,5	149	76,5	870	2	2
381088451	88,9	144	159	84	1365	2	2
381108451	108	169	199	94	1922	2	2

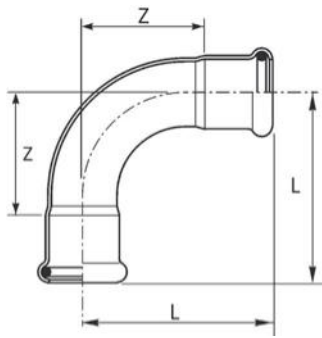

**381/900**

≤54 B 20 21

≥76 B 20 22

Curva 90° FF  
90° Elbow FF  
Bogen 90° II  
Coude FF 90°  
Curva 90° HH

Materiale: E 195 - 1.0034  
O-ring: EPDM nero - black - Schwarz - noir - negro

CODICE CODE	De	L mm	Z mm			
381012900	12	42	24	42	20	400
381015900	15	38	18	44	20	400
381018900	18	41,5	21,5	55	20	300
381022900	22	47	26	73	10	150
381028900	28	56	33	109	10	100
381035900	35	68	42	156	5	50
381042900	42	80	50	231	2	30
381054900	54	100	64	369	2	18
381076900	76,1	160	105	1150	2	2
381088900	88,9	182	122	1560	2	2
381108900	108	220	145	2250	2	2

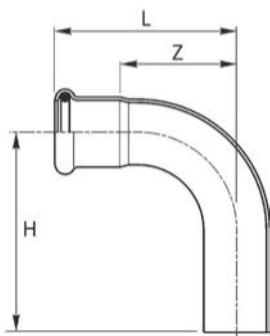

**381/901**

≤54 B 20 21

≥76 B 20 22

Curva 90° MF  
90° Elbow MF  
Bogen 90° IA  
Coude MF 90°  
Curva 90° HM

Materiale: E 195 - 1.0034  
O-ring: EPDM nero - black - Schwarz - noir - negro

CODICE CODE	De	L mm	H mm	Z mm			
381012901	12	42	48	24	46	20	400
381015901	15	38	48	18	44	20	400
381018901	18	41,5	48,5	21,5	56	20	300
381022901	22	47	57	26	77	10	150
381028901	28	56	64	33	113	10	100
381035901	35	68	82	42	174	5	50
381042901	42	80	101	50	235	2	30
381054901	54	100	120	64	385	2	18
381076901	76,1	160	180	105	1155	2	2
381088901	88,9	182	197	122	1585	2	2
381108901	108	220	236	145	2155	2	2

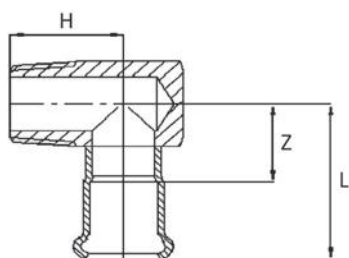

## 385

### Gomito misto 90° filetto M

Elbow adapter 90° with male thread

Übergangswinkel 90° AG

Equerre 90° avec filetage M

Codo macho

Materiale: E 195 - 1.0034

O-ring: EPDM nero - black - Schwarz - noir - negro

Filettatura: EN 10226-1 (ex ISO 7/1)

CODICE CODE	De x R mm x inch	L mm	H mm	Z mm			
385308015	15 x 3/8"	36	21	16	90	20	200
385102015	15 x 1/2"	37	26	17	94	20	200
385102018	18 x 1/2"	37	26	17	105	20	200
385304022	22 x 3/4"	41	29	20	149	10	100

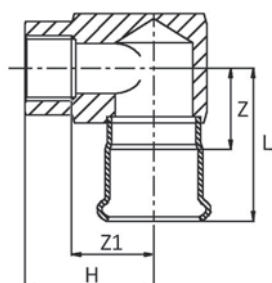

## 398

### Gomito misto 90° filetto F

Elbow adapter 90° with female thread

Übergangswinkel 90° IG

Equerre 90° avec filetage F

Codo hembra

Materiale: E 195 - 1.0034

O-ring: EPDM nero - black - Schwarz - noir - negro

Filettatura: EN 10226-1 (ex ISO 7/1)

CODICE CODE	De x Rp mm x inch	L mm	H mm	Z mm	Z1 mm			
398304022	22 x 3/4"	46	44	25	27	270	10	100
398102028	28 x 1/2"	49	42	26	27	300	10	50
398304028	28 x 3/4"	49	47	26	30	330	10	50

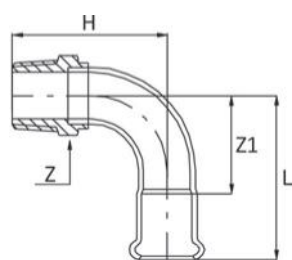

## 397

### Curva filettata 90° filetto M

90° Elbow BSP

Bogen 90° mit AG

Coude 90° avec filetage M

Codo a 90° MF

Materiale: E 195 - 1.0034

O-ring: EPDM nero - black - Schwarz - noir - negro

Filettatura: EN 10226-1 (ex ISO 7/1)

CODICE CODE	De x R mm x inch	L mm	H mm	Z mm	Z1 mm			
397308012	12 x 3/8"	42	34	22	24	42	20	300
397308015	15 x 3/8"	50	47,5	21	30	65	20	300
397102015	15 x 1/2"	50	47	21	30	70	20	300
397102018	18 x 1/2"	54	52	24	34	90	20	200
397304022	22 x 3/4"	60	62	30	39	130	10	100
397100028	28 x 1"	73	74	36	50	192	10	50
397114035	35 x 1 1/4"	68	80	46	42	262	5	40
397112042	42 x 1 1/2"	80	98	60	50	413	2	20
397200054	54 x 2"	100	131,5	65	65	482	2	12



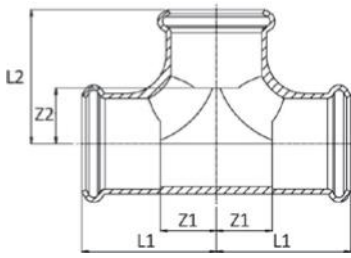

## 382

≤54 B 20 21

≥76 B 20 22

"T"

Equal tee

T-Stück

Té égal

Te igual HHH

Materiale: E 195 - 1.0034

O-ring: EPDM nero - black - Schwarz - noir - negro

CODICE CODE	De	L1 mm	L2 mm	Z1 mm	Z2 mm	g	Box	Carton
382012000	12	28	35	10	17	48	20	200
382015000*	15	32	32	10,5	10,5	72	20	200
382018000*	18	34	34	12,5	12,5	85	20	100
382022000*	22	37	37	14,5	14,5	116	20	100
382028000*	28	42	42	17,5	17,5	173	10	50
382035000*	35	50	50	22,5	22,5	240	4	32
382042000*	42	57	57	25,5	25,5	337	4	20
382054000*	54	69	69	32,5	32,5	473	2	12
382076000	76,1	108	118	52	63	1275	2	2
382088000	88,9	132	131	72	71	1535	2	2
382108000	108	155	159	74	84	2115	2	2

(\*): idroformato - hydroformed - hydrogeformt - hydroformé - hidroformado

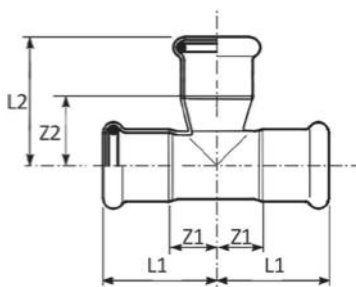

## 392/A

B 20 21

Tee allargato

Tee oversize branch

T-Stück mit erweitertem Abgang

Té avec sortie évasée

T con salida ensanchada

Materiale: E 195 - 1.0034

O-ring: EPDM nero - black - Schwarz - noir - negro

CODICE CODE	De	L1 mm	L2 mm	Z1 mm	Z2 mm	g	Box	Carton
392012015	12 x 15 x 12	28	38	10	17	52	20	100
392015018	15 x 18 x 15	37	36	16	15	71	20	100
392015022	15 x 22 x 15	37	42	16	19	84	10	100
392018022	18 x 22 x 18	40	45	19	22	97	10	100
392022028	22 x 28 x 22	41	45	18	21	123	10	50

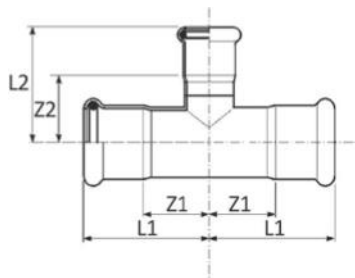

## 392

"T" ridotto

Reducing tee

T-Stück mit reduziertem Abgang

Té réduit

Te reducida HHH

Materiale: E 195 - 1.0034

O-ring: EPDM nero - black - Schwarz - noir - negro

≤54 B 20 21

≥76 B 20 22

CODICE CODE	De	L1 mm	L2 mm	Z1 mm	Z2 mm			
392015012	15 x 12 x 15	37	33	16	15	64	20	100
392018012	18 x 12 x 18	40	34	19	16	72	20	100
392018015	18 x 15 x 18	37	41	16	21	80	20	100
392022012	22 x 12 x 22	41	36	18	18	94	10	100
392022015	22 x 15 x 22	39	43	18	23	91	10	100
392022018	22 x 18 x 22	39	44	18	23	93	10	100
392028015	28 x 15 x 28	44	46	21	26	121	10	50
392028018	28 x 18 x 28	44	46	21	26	123	10	50
392028022	28 x 22 x 28	44	47	21	26	132	10	50
392035015	35 x 15 x 35	51	49	25	29	159	5	50
392035018	35 x 18 x 35	51	50	25	30	163	5	50
392035022	35 x 22 x 35	51	51	25	30	167	5	50
392035028	35 x 28 x 35	51	54	25	31	177	5	35
392042022	42 x 22 x 42	59	54	28	33	228	4	20
392042028	42 x 28 x 42	59	57	28	34	239	4	20
392042035	42 x 35 x 42	59	61	28	35	250	4	20
392054022	54 x 22 x 54	70	62	34	41	325	2	16
392054028	54 x 28 x 54	70	65	34	42	336	2	16
392054035	54 x 35 x 54	70	68	34	42	345	2	16
392054042	54 x 42 x 54	70	72	34	42	365	2	16
392076022	76,1 x 22 x 76,1	108	74	52	53	995	2	2
392076028	76,1 x 28 x 76,1	108	77	52	54	1015	2	2
392076035	76,1 x 35 x 76,1	108	80	52	54	1025	2	2
392076042	76,1 x 42 x 76,1	108	84	52	54	1045	2	2
392076054	76,1 x 54 x 76,1	108	90	52	55	1065	2	2
392088028	88,9 x 28 x 88,9	132	84	72	61	1365	2	2
392088035	88,9 x 35 x 88,9	132	88	72	62	1395	2	2
392088042	88,9 x 42 x 88,9	132	91	72	61	1425	2	2
392088054	88,9 x 54 x 88,9	132	97	72	62	1455	2	2
392088076	88,9 x 76,1 x 88,9	132	125	72	70	1485	2	2
392108028	108 x 28 x 108	155	94	74	71	1815	2	2
392108035	108 x 35 x 108	155	97	74	71	1845	2	2
392108042	108 x 42 x 108	155	101	74	71	1875	2	2
392108054	108 x 54 x 108	155	107	74	72	1905	2	2
392108076	108 x 76 x 108	155	135	74	80	1935	2	2
392108088	108 x 88,9 x 108	155	141	74	81	1965	2	2

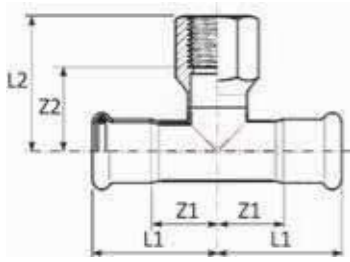

## 389

≤54 B 20 21

≥76 B 20 22

"T" con derivazione filetto F

Branch tee female BSP outlet

T-Stück mit Abgang IG

Té mixte avec filetage F

Te hembra roscada

Materiale: E 195 - 1.0034

O-ring: EPDM nero - black - Schwarz - noir - negro

Filettatura: EN 10226-1 (ex ISO 7/1)

CODICE CODE	De x Rp x De mm x inch x mm	L1 mm	L2 mm	Z1 mm	Z2 mm			
389102015	15 x 1/2" x 15	35	36	14	21	72	20	100
389102018	18 x 1/2" x 18	37	38	16	23	91	20	100
389102022	22 x 1/2" x 22	39	39	18	24	128	10	100
389304022	22 x 3/4" x 22	39	44	18	28	133	10	100
389102028	28 x 1/2" x 28	44	42	21	27	158	10	50
389304028	28 x 3/4" x 28	44	47	21	30	161	10	50
389100028	28 x 1" x 28	44	53	21	34	246	5	50
389102035	35 x 1/2" x 35	51	45	25	30	200	5	50
389304035	35 x 3/4" x 35	51	50	25	34	191	5	40
389100035	35 x 1" x 35	51	56	25	37	250	5	40
389102042	42 x 1/2" x 42	59	49	28	34	255	4	32
389304042	42 x 3/4" x 42	59	54	28	37	255	4	32
389102054	54 x 1/2" x 54	70	56	34	41	300	2	14
389304054	54 x 3/4" x 54	70	61	34	45	353	2	14
389102076	76,1 x 1/2" x 76,1	108	68	52	53	361	2	2
389304076	76,1 x 3/4" x 76,1	108	77	52	60	400	2	2
389102088	88,9 x 1/2" x 88,9	132	76	72	61	1040	2	2
389304088	88,9 x 3/4" x 88,9	132	84	72	68	1040	2	2
389102108	108 x 1/2" x 108	155	85	74	70	1255	2	2
389304108	108 x 3/4" x 108	155	94	74	77	1255	2	2

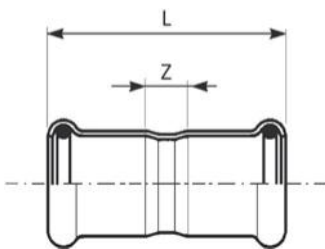

## 383/000

≤54 B 20 21

≥76 B 20 22

Manicotto

Coupling

Muffe

Manchon

Manguito HH

Materiale: E 195 - 1.0034

O-ring: EPDM nero - black - Schwarz - noir - negro

CODICE CODE	De	L mm	Z mm			
383012000	12	42	6	25	20	500
383015000	15	49	9	33	20	500
383018000	18	50	10	40	20	300
383022000	22	53	11	52	20	200
383028000	28	56	10	69	10	150
383035000	35	63	10	90	10	100
383042000	42	72	12	127	4	60
383054000	54	83	13	189	2	24
383076000	76,1	142	32	635	4	4
383088000	88,9	166	46	765	4	4
383108000	108	203	41	1170	2	2

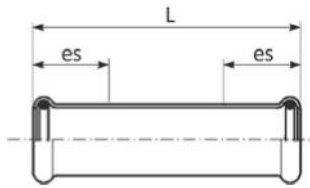

## 383/001

≤54 B 20 21

≥76 B 20 22

### Manicotto passante

Slip coupling

Schiebemuffe

Manchon long

Manguito sin tope

Materiale: E 195 - 1.0034

O-ring: EPDM nero - black - Schwarz - noir - negro

CODICE CODE	De	L mm	es	g		
383012001	12	56	22	42	20	500
383015001	15	69	25	56	20	200
383018001	18	73	25	65	20	200
383022001	22	79	25	85	20	100
383028001	28	88,5	30	118	10	100
383035001	35	102,5	30	141	10	50
383042001	42	117,5	40	234	4	40
383054001	54	139	40	321	4	20
383076001	76,1	230	60	940	2	2
383088001	88,9	260	70	1240	2	2
383108001	108	310	80	1835	2	2

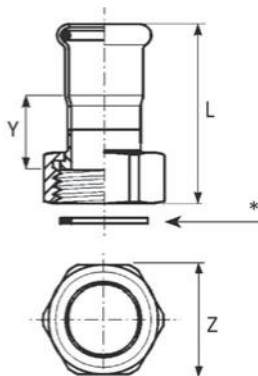

## 383/002

B 20 21

### Manicotto con dado folle

Valve connector

Anschlussverschraubung

Raccord écrou libre

Rácor dos piezas

Materiale: E 195 - 1.0034

O-ring: EPDM nero - black - Schwarz - noir - negro

Guarnizione: (\*) EPDM nero - black - Schwarz - noir - negro

Filettatura: ISO 228/1 (ex DIN 259)

CODICE CODE	De x G mm x inch	L mm	Z mm	Y mm	g		
383015002	15 x 3/4"	37	30	10	60	10	250
383018002	18 x 3/4"	37	30	10	68	10	250
383022012	22 x 3/4"	54	30	25	103	10	200
383022002	22 x 1"	40	36	10	86	10	200
383028012	28 x 1"	58	36	27	142	10	150
383028002	28 x 1 1/4"	47	46	14	136	10	150
383035012	35 x 1 1/4"	67	46	32	237	4	60
383035002	35 x 1 1/2"	52	55	14	292	4	60
383042022	42 x 1 1/2"	77	55	35	422	2	60
383042002	42 x 1 3/4"	55	60	14	360	2	60
383042012	42 x 2"	56	65	14,5	310	2	40
383054012	54 x 2"	83	65	36,5	475	2	30
383054002	54 x 2 3/8"	60	75	15	442	2	40
383054022	54 x 2 1/2"	65,5	81	16	537	2	24

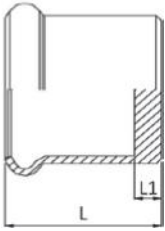

**383/003**

≤54 B 20 21

≥76 B 20 22

**Tappo di chiusura**  
 Stop end  
 Verschlusskappe  
 Bouchon d'obturation  
 Tapón

Materiale: E 195 - 1.0034  
 O-ring: EPDM nero - black - Schwarz - noir - negro

CODICE CODE	De	L mm	L1 mm			
383012003	12	30	13	21	20	500
383015003	15	26	5	28	20	500
383018003	18	26	5	30	10	300
383022003	22	27	5	40	10	200
383028003	28	29	5	57	10	150
383035003	35	32	5	80	5	100
383042003	42	36	5	115	4	80
383054003	54	41	5	177	4	40
383076003	76,1	78	6	540	2	10
383088003	88,9	88	6	730	2	10
383108003	108	102	6	935	2	2

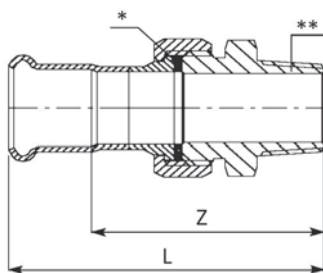

**384/000**

B 20 21

**Bocchettoni a sede piana filetto M**  
 Straight male union connector  
 Durchgangverschraubung mit Aussengewinde  
 Raccord union fileté  
 Rácor 3 Piezas roscado macho

Materiale: E 195 - 1.0034  
 Raccordo: (\*\*): ottone - brass - Messing - laiton - latón  
 O-ring: EPDM nero - black - Schwarz - noir - negro  
 Guarnizione: (\*): EPDM nero - black - Schwarz - noir - negro  
 Filettatura: EN 10226-1 (ex ISO 7/1)

CODICE CODE	De x R mm x inch	L mm	Z mm			
384015000	15 x 1/2"	64	44	146	2	120
384018000	18 x 1/2"	64	44	176	2	120
384022000	22 x 3/4"	68	46	202	2	100
384028000	28 x 1"	80	56	468	2	60
384035000	35 x 1 1/4"	89	62	618	2	40
384042000	42 x 1 1/2"	92	61	824	2	30
384054000	54 x 2"	102	66	1178	2	20

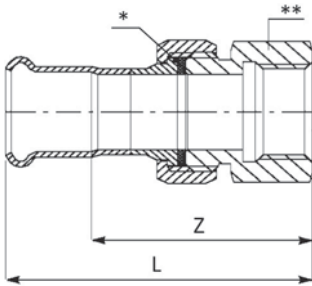

## 384/001

**Bocchettoni a sede piana filetto F**

Straight female union connector

Durchgangsverschraubung mit Innengewinde

Raccord union taraudé

Rácor 3 Piezas hembra

Materiale: E 195 - 1.0034

Raccordo: (\*\*): ottone - brass - Messing - laiton - latón

O-ring: EPDM nero - black - Schwarz - noir - negro

Guarnizione: (\*) EPDM nero - black - Schwarz - noir - negro

Filettatura: EN 10226-1 (ex ISO 7/1)

CODICE CODE	De x Rp mm x inch	L mm	Z mm			
384015001	15 x 1/2"	58	38	138	2	120
384018001	18 x 1/2"	58	38	140	2	120
384022001	22 x 3/4"	63	41	209	2	100
384028001	28 x 1"	73	49	450	2	60
384035001	35 x 1 1/4"	81	54	600	2	40
384042001	42 x 1 1/2"	84	53	621	2	30
384054001	54 x 2"	102	66	1189	2	20

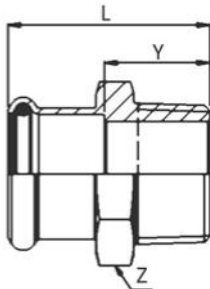

## 387

**Manicotto misto filetto M**

Male adapter

Übergangsstück mit AG

Raccord avec filetage male

Unión macho

Materiale: E 195 - 1.0034

O-ring: EPDM nero - black - Schwarz - noir - negro

Filettatura: EN 10226-1 (ex ISO 7/1)

**≤54 B 20 21**
**≥76 B 20 22**

CODICE CODE	De x R mm x inch	L mm	Z mm	Y mm			
387308012	12 x 3/8"	36	19	18	31	20	300
387308015	15 x 3/8"	38	24	18	44	20	400
387102015	15 x 1/2"	41	24	21	53	20	300
387304015	15 x 3/4"	43	27	23	77	10	200
387102018	18 x 1/2"	41	27	21	54	20	300
387304018	18 x 3/4"	44	30	24	88	10	200
387102022	22 x 1/2"	42	32	21	60	10	200
387304022	22 x 3/4"	44	32	23	89	10	200
387100022	22 x 1"	46	36	25	154	10	100
387304028	28 x 3/4"	47	38	24	114	10	100
387100028	28 x 1"	48	38	25	116	10	100
387114028	28 x 1 1/4"	52	46	29	195	5	50
387100035	35 x 1"	52	46	25	169	5	50
387114035	35 x 1 1/4"	56	46	29	205	5	50
387112035	35 x 1 1/2"	55	50	28	220	5	50
387112042	42 x 1 1/2"	63	55	33	250	4	40
387200054	54 x 2"	72	65	36	356	4	32
387212076	76,1 x 2 1/2"	124	80	69	780	2	8
387300088	88,9 x 3"	141	95	81	1135	2	4
387400108	108 x 4"	162	115	88	1400	2	2

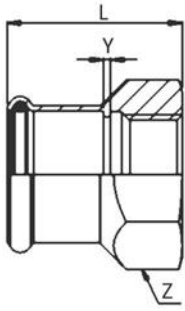

**390**

**Manicotto misto filetto F**  
 Female adapter  
 Übergangsstück mit IG  
 Raccord avec filetage femelle  
 Unión hembra

Materiale: E 195 - 1.0034  
 O-ring: EPDM nero - black - Schwarz - noir - negro  
 Filettatura: EN 10226-1 (ex ISO 7/1)

CODICE CODE	De x Rp mm x inch	L mm	Z mm	Y mm			
390102012	12 x 1/2"	38	27	3	55	20	300
390308015	15 x 3/8"	35	24	2	48	20	300
390102015	15 x 1/2"	38	27	2	60	20	300
390304015	15 x 3/4"	39	32	2	78	10	200
390102018	18 x 1/2"	38	27	2	60	20	300
390304018	18 x 3/4"	39	32	2	78	10	200
390102022	22 x 1/2"	39	32	2	96	10	200
390304022	22 x 3/4"	40	32	2	81	10	150
390100022	22 x 1"	43	41	2	147	10	100
390102028	28 x 1/2"	41	38	2	155	20	100
390304028	28 x 3/4"	42	38	2	132	10	100
390100028	28 x 1"	45	41	2	147	10	100
390100035	35 x 1"	51	46	2	218	5	100
390114035	35 x 1 1/4"	52	46	2	154	5	50
390112042	42 x 1 1/2"	56	55	2	245	4	40
390200054	54 x 2"	65	65	2	329	4	32

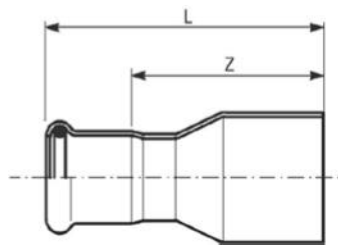

## 391

≤54 B 20 21

≥76 B 20 22

**Riduzione MF**  
 Reducer  
 Reduzierstück  
 Reduction  
 Reducción MH

Materiale: E 195 - 1.0034

O-ring: EPDM nero - black - Schwarz - noir - negro

CODICE CODE	De	L mm	Z mm	g	Box	Box
391015012	15 x 12	51	33	29	20	500
391018012	18 x 12	53	35	32	20	500
391018015	18 x 15	57	37	36	20	500
391022012	22 x 12	60	42	41	20	500
391022015	22 x 15	64	44	45	20	400
391022018	22 x 18	60	40	48	20	300
391028015	28 x 15	76,5	56,5	50	20	200
391028018	28 x 18	75	55	54	20	200
391028022	28 x 22	65	42,5	59	20	200
391035022	35 x 22	70	49	89	10	100
391035028	35 x 28	71	48	91	10	100
391042022	42 x 22	97	76	120	4	100
391042028	42 x 28	93	70	127	4	80
391042035	42 x 35	81	55	130	4	40
391054022	54 x 22	95	74	140	4	40
391054028	54 x 28	108,5	85,5	155	4	40
391054035	54 x 35	108	82	192	4	40
391054042	54 x 42	97,5	67,5	205	4	32
391076042	76,1 x 42	143	113	480	4	4
391076054	76,1 x 54	148	112	480	4	4
391088054	88,9 x 54	161	125	585	4	4
391088076	88,9 x 76,1	184	129	675	4	4
391108076	108 x 76,1	203	148	900	2	2
391108088	108 x 88,9	210	150	1050	2	2

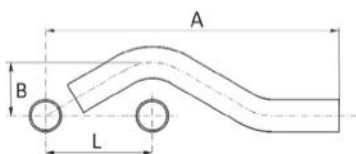

## 379

B 20 21

**"S" di Scavalamento MM**  
 Pipe bridge  
 Sprungbogen  
 "S" De Chevauchement male  
 "S" De superposicìon MM

Materiale: E 195 - 1.0034

CODICE CODE	De	L mm	A mm	B mm	g	Box	Box
379012000	12	55	154	35	10	10	150
379015000	15	57	158	37	14	10	150
379018000	18	60	165	40	17	10	100
379022000	22	65	178	44	29	10	100
379028000	28	74	210	50	44	10	50



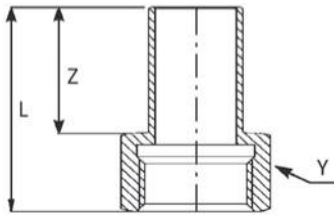

**393**

**Manicotto con inserimento filetto F**  
 Female reduction socket  
 Übergang Innengewinde mit Einschubende  
 Manchon de réduction avec taraudage  
 Adaptador hembra  
 Materiale: E 195 - 1.0034

CODICE CODE	De x Rp mm x inch	L mm	Z mm	Y mm			
393102015	15 x 1/2"	52	37	24	49	20	400
393102018	18 x 1/2"	52	37	24	50	20	400
393304018	18 x 3/4"	51	37	30	62	20	300
393102022	22 x 1/2"	52	37	24	51	20	300
393304022	22 x 3/4"	52	38	30	63	20	300

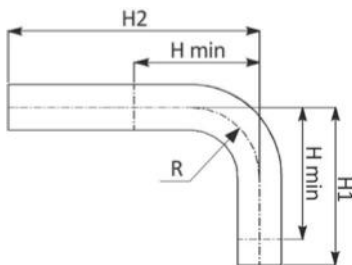

**394/900**

**Tubo curvo 90°**  
 90° Elbow MM  
 Passbogen 90°  
 Coude d'ajustement 90°  
 Tubo ricurvo 90° MM  
 Materiale: E 195 - 1.0034

CODICE CODE	De	H1 mm	H min mm	H2 mm	R mm			
394015900	15	70	48	120	35	16	20	160
394018900	18	70	53	120	38	20	20	160
394022900	22	70	61	120	40	31	10	100
394028900	28	97	80	125	45	42	10	50
394035900	35	120	90	200	54	58	4	20
394042900	42	160	115	250	76	130	2	10
394054900	54	300	140	305	97	210	2	10

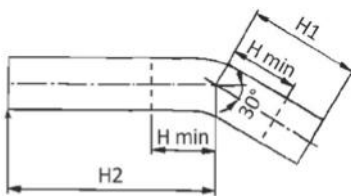

**394/300**

**Tubo curvo 30°**  
 30° Elbow MM  
 Passbogen 30°  
 Coude d'ajustement 30°  
 Tubo ricurvo 30° MM  
 Materiale: E 195 - 1.0034

CODICE CODE	De	H1 mm	H min mm	H2 mm			
394028300	28	54	47	130	42	10	50
394035300	35	80	50	218	58	4	24
394042300	42	98	54	274	130	2	10
394054300	54	137	72	324	210	4	4

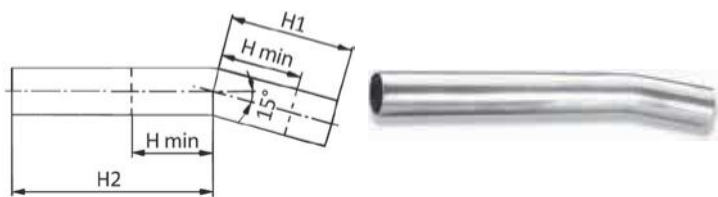

## 394/150

**Tubo curvo 15°**  
 15° Elbow MM  
 Passbogen 15°  
 Coude d'ajustement 15°  
 Tubo ricurvo 15° MM  
 Materiale: E 195 - 1.0034

CODICE CODE	De	H1 mm	H min mm	H2 mm			
394028150	28	45	38	136	42	10	50
394035150	35	62	32	234	58	4	24
394042150	42	94	50	276	130	2	10
394054150	54	117	52	337	210	4	4

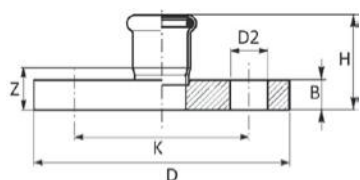

## 393/000

**Manicotto flangiato**  
 Adaptor flange  
 Übergangsflansch  
 Bride de raccordement  
 Brida adaptador

Materiale: E 195 - 1.0034  
 O-ring: EPDM nero - black - Schwarz - noir - negro

**PN 16**
**≤54 B 20 21**
**≥76 B 20 22**

CODICE CODE	De	DN flg	H mm	Z mm	B mm	D mm	D2 mm	N° fori Holes Nr.	K mm			
393015000	15	15	43	23	16	95	14	4	65	578	2	20
393018000	18	15	44	24	16	95	14	4	65	572	2	20
393022000	22	20	47	26	18	105	14	4	75	754	2	14
393028000	28	25	50	27	18	115	14	4	85	1094	2	10
393035000	35	32	53	27	18	140	18	4	100	1672	2	6
393042000	42	40	57	27	18	150	18	4	110	1988	2	8
393054000	54	50	64	28	18	165	18	4	125	2666	2	6
393076000	76,1	65	97	42	18	185	18	8	145	3450	2	2
393088000	88,9	80	108	48	20	200	18	8	160	4150	2	2
393108000	108	100	124	49	20	220	18	8	180	4905	2	2

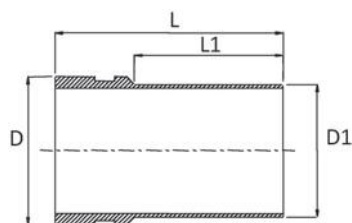

## 322

**Raccordo di transizione Steelpres tubazioni scanalate a giunti rapidi**  
 Transition piece Steelpres/Couplings  
 Übergang Steelpres/Kupplung  
 Racord de passage entre Steelpres et tube canelé  
 Racor de transición Steelpres/Tubería canalada  
 Materiale: E 275+N - 1.0225

CODICE CODE	D mm	D1 mm	L mm	L1 mm			
322060042	60	42	120	69	410	1	25
322060054	60	54	120	80	410	1	20
322076054	76	54	130	76	585	1	15

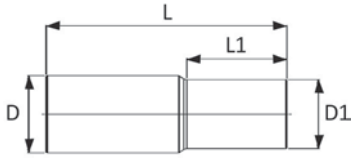

**375**

**Giunto a saldare senza zincatura**



Combination pipe welding end (not galvanized)

Kombirohr mit Anschweißende (nicht verzinkt)

Tube réduit avec extrémité à souder (non galvanisé)

Union a saldar sin zincadura

Materiale: E 195 - 1.0034

CODICE CODE	D mm	D1 mm	L mm	L1 mm			
375308012	17,2	12	120	26	124	10	100
375308015	17,2	15	120	30	89	10	100
375102018	21,3	18	120	30	132	10	100
375304022	26,9	22	120	34	216	10	100
375100028	33,7	28	120	34	303	5	80
375114035	42,4	35	120	40	423	5	50
375112042	48,3	42	120	45	438	5	40
375200054	60,3	54	120	50	537	2	24